

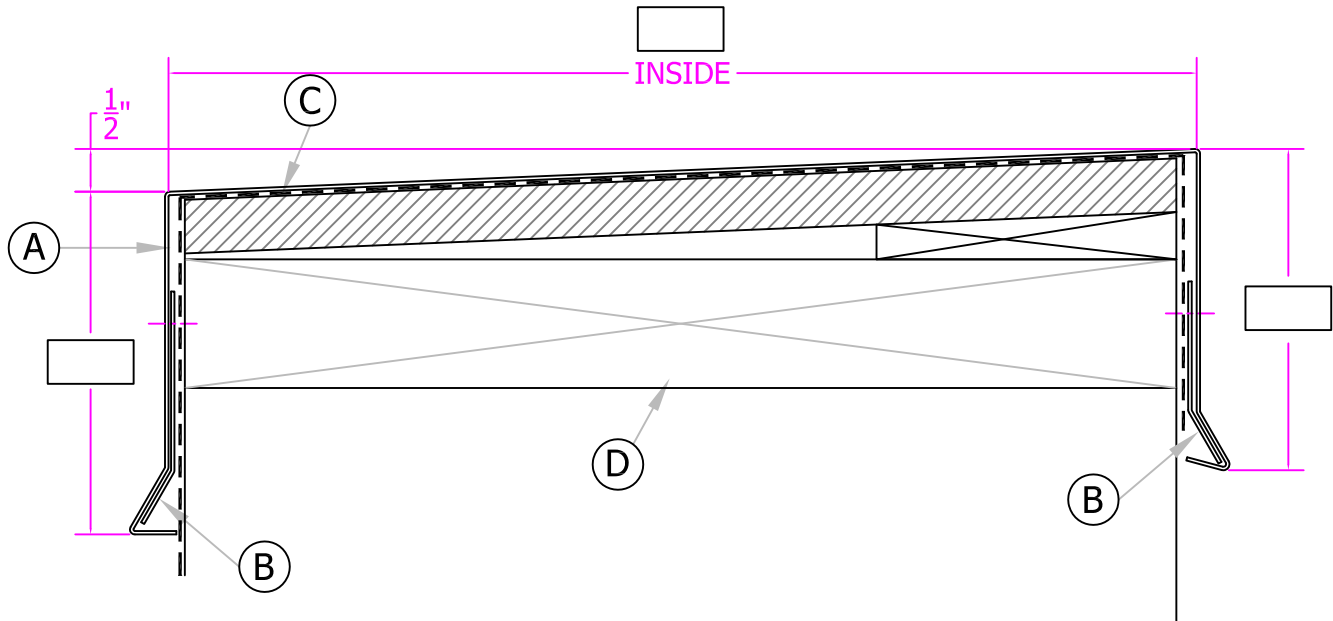

**SUBMITTAL / DATA SHEET**

**CP Coping**



Available Thickness
0.040" Aluminum
0.050" Aluminum
0.063" Aluminum
0.080" Aluminum
0.090" Aluminum
0.125" Aluminum

- (A) Coping Body; 10' Lengths; Joint treatment consist of a 3/8" expansion reveal with 6" wide 0.050" aluminum concealed splice plate. Gasket strips are field applied full width and on both side of the concealed splice plate
- (B) Continuous Cleats (Both sides).
- (C) Elastomeric roof membrane extends over parapet and face fastened - see membrane manufacturer's specs.
- (D) Continuous wood plate and roof parapet.

**CP Coping System Description:** CP Coping is a versatile series of coping products custom manufactured for your job. Its' concealed continuous cleats (if quoted) eliminate exposed fasteners and makes installation fast and easy. Joint treatment consist of a 6" wide concealed splice plate with a 3/8" expansion reveal. Copings are produced in 10 foot lengths. Purchaser must provide field verified coping widths. Cleats are an optional accessory.

Customer:

Project:

Address:

Location:

Phone / Fax:

Architect: