

# SUBMITTAL / DATA SHEET

Perimeter  
Systems

*Innovative Aluminum Architecture*

A division of



8370 East Hwy 78  
Villa Rica, GA 30180  
800-334-9823 770-942-1207 Fax 942-4173

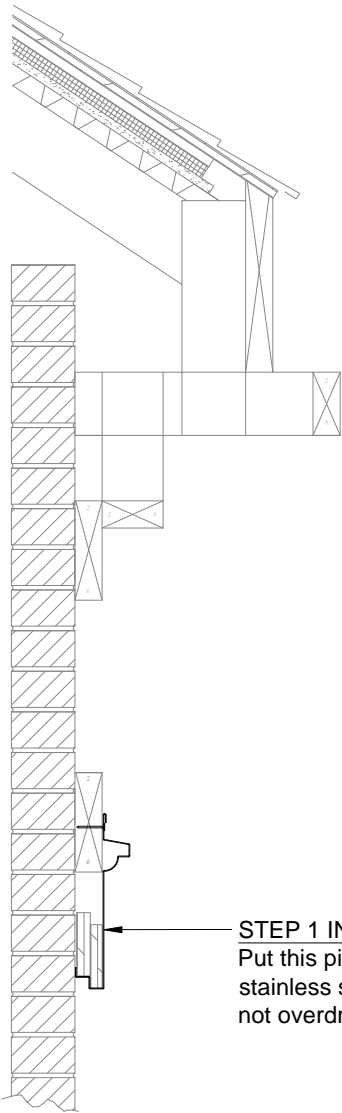

**STEP 1 INSTALL E**  
Put this piece snug against the plywood and use #10x1" stainless screws to fasten this piece to the 2x. Do not overdrive the screws as this will cause oil canning.

SUBMITTAL / DATA SHEET

Perimeter  
Systems

*Innovative Aluminum Architecture*

A division of



8370 East Hwy 78  
Villa Rica, GA 30180  
800-334-9823 770-942-1207 Fax 942-4173

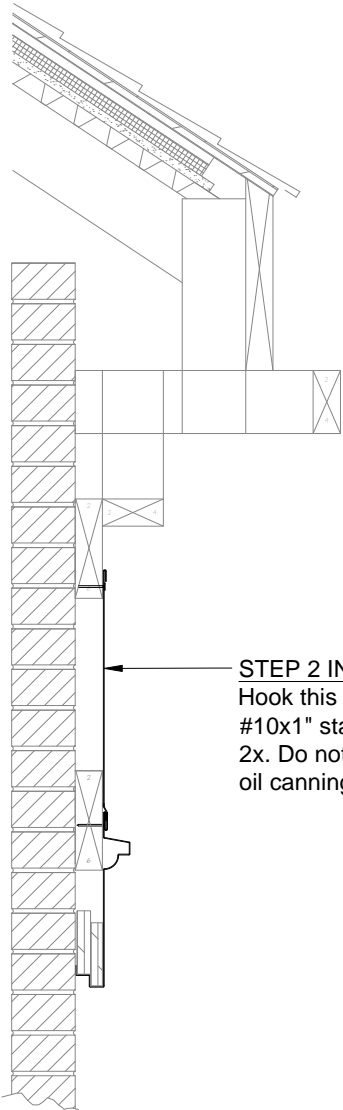

**STEP 2 INSTALL D**  
Hook this piece into lower frieze moulding and use #10x1" stainless screws to fasten this piece to the 2x. Do not overdrive the screws as this will cause oil canning.

# SUBMITTAL / DATA SHEET

Perimeter  
Systems

*Innovative Aluminum Architecture*

A division of



8370 East Hwy 78  
Villa Rica, GA 30180  
800-334-9823 770-942-1207 Fax 942-4173

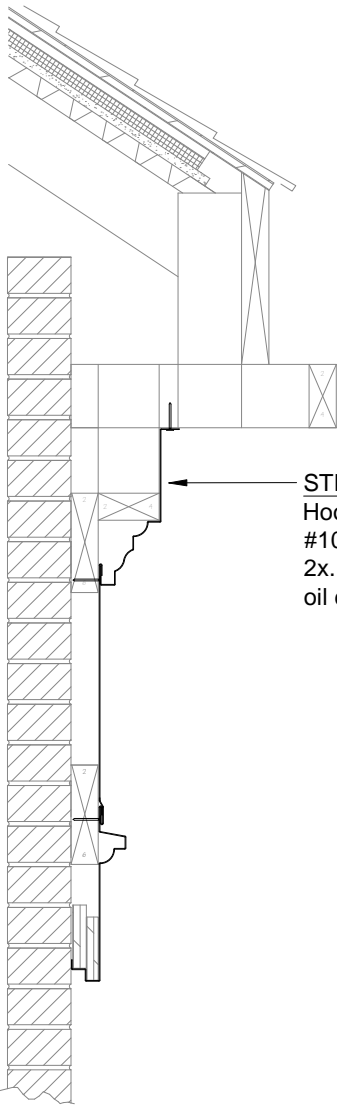

**STEP 3 INSTALL C**

Hook this piece into lower frieze extender and use #10x1" stainless screws to fasten this piece to the 2x. Do not overdrive the screws as this will cause oil canning.

SUBMITTAL / DATA SHEET

Perimeter  
Systems

*Innovative Aluminum Architecture*

A division of



8370 East Hwy 78  
Villa Rica, GA 30180  
800-334-9823 770-942-1207 Fax 942-4173

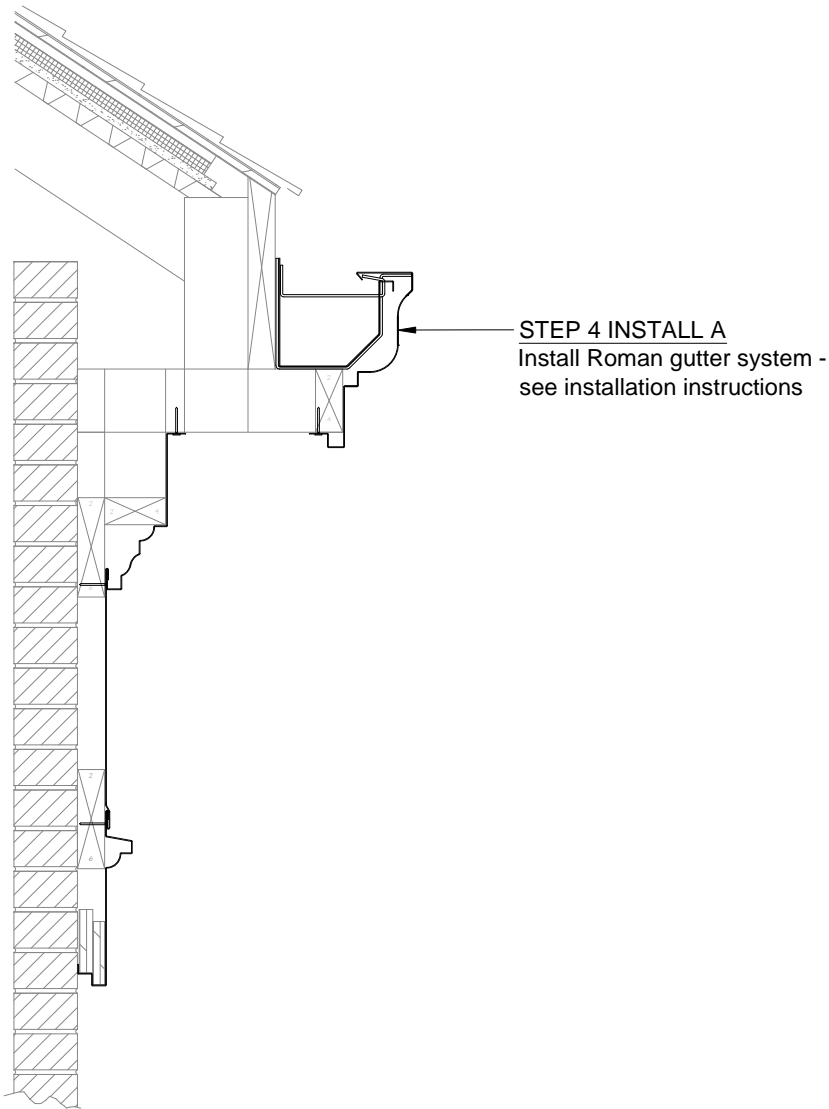

SUBMITTAL / DATA SHEET

Perimeter  
Systems

*Innovative Aluminum Architecture*

A division of



8370 East Hwy 78  
Villa Rica, GA 30180  
800-334-9823 770-942-1207 Fax 942-4173

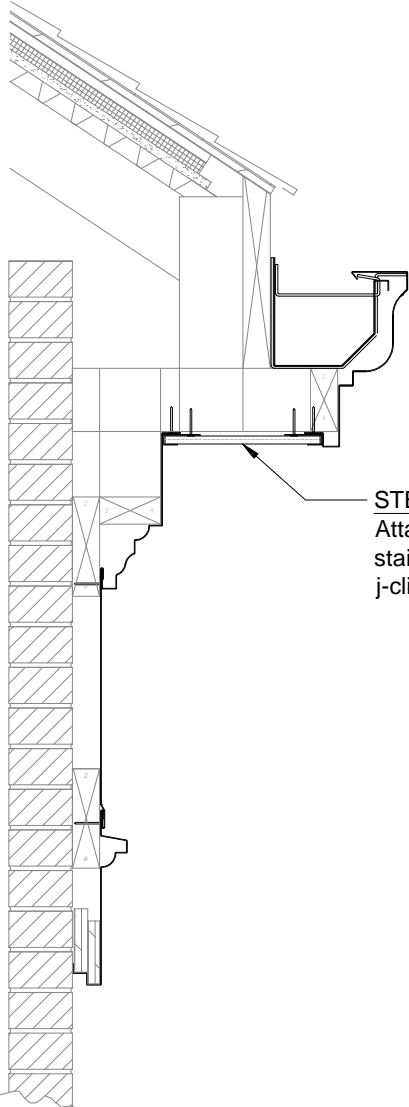

**STEP 5 INSTALL B**  
Attach J-clips to 2x framing with #10x1"  
stainless screws then slide soffit panel into  
j-clips.