

SUBMITTAL / DATA SHEET

Perimeter
Systems

Innovative Aluminum Architecture

A division of **SAF**

8370 East Hwy 78
Villa Rica, GA 30180
800-334-9823 770-942-1207 Fax 942-4173

Crown Cornice Mouldings

- ① Style 1 Cornice Crown is designed for fascia mounting. Its lower edge accommodates soffits, other mouldings, or the soffit lip may be eliminated for a closed fit.
- ② Style 2 Cornice Crown is designed for soffit mounting. It is designed as an intermediate moulding to accommodate soffits, or other mouldings. This cornice moulding is used in our Cornice Design #8.

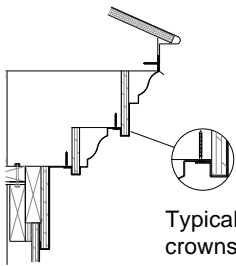

Typical eave design with multiple crowns and a frieze.

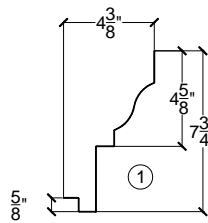

Deck flanges are available and convenient for rake edge details.

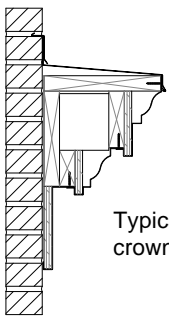

Typical parapet design with multiple crowns and a frieze.

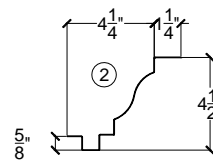
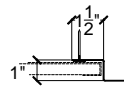

All Cornice Crown Mouldings are available for adjoining soffits. The mouldings lower edge is configured for fastening to the cornice framing after which soffit panels and J-moulding are applied.

Drawing No. 53

SUBMITTAL / DATA SHEET

Perimeter
Systems

Innovative Aluminum Architecture

A division of **SAF**

8370 East Hwy 78
Villa Rica, GA 30180
800-334-9823 770-942-1207 Fax 942-4173

Crown Cornice Mouldings

- ③ Style 3 Cornice Crown is designed for fascia mounting. Its lower edge accommodates soffits or other mouldings. The soffit leg may be hemmed and hooked onto brackets for a stand-alone moulding.
- ④ Style 4 Cornice Crown is designed for soffit mounting. As with Style 3, the soffit leg may be hemmed and hooked onto brackets for a stand-alone moulding.
- ⑤ Style 5 Cornice Crown is designed for eave and fascia mounting. Its lower edge accommodates soffits or other mouldings. The soffit leg may be hemmed and hooked onto brackets for a stand-alone moulding.
- ⑥ Style 6 Cornice Crown is designed for fascia mounting. Its lower edge accommodates soffits or other mouldings. It is commonly used as a termination or stand-alone moulding.
- ⑦ Style 7 Cornice Crown is designed for soffit mounting. This cornice moulding is used in our Cornice Design #8.

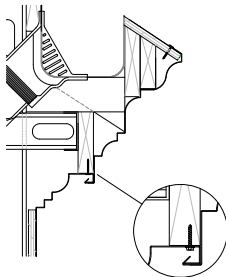
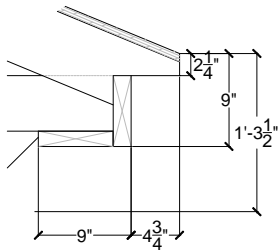

Typical installation

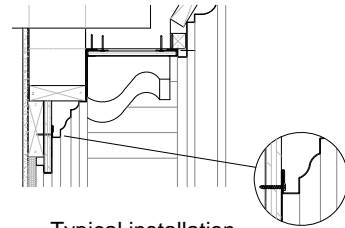

Typical installation

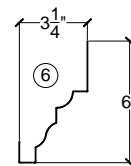
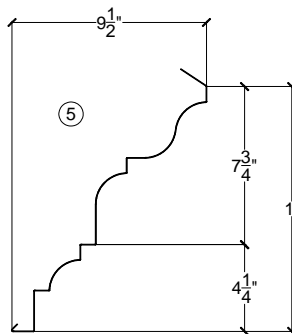
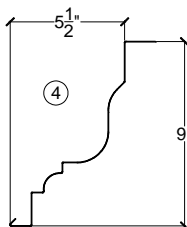
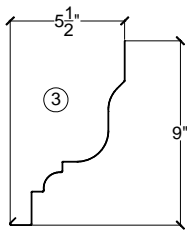

Crown cornice moulding 6 & 7 are available with soffit or bracket closure legs.

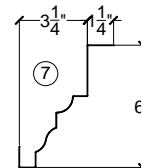

Drawing No. 54